

PUSH SWITCHES

2212 series

2212

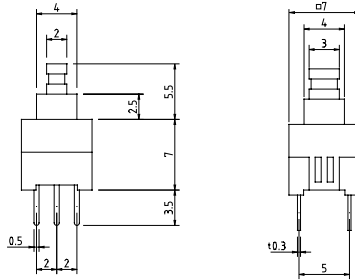
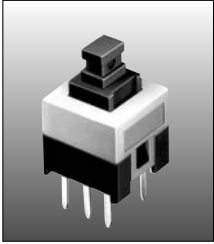

Model No.	Operating Mode	Stroke	Operating Force
2212S	Self-Lock	Full:1.8mm	200±80gf
2212N	Non-Lock	Lock:1mm	

2212F

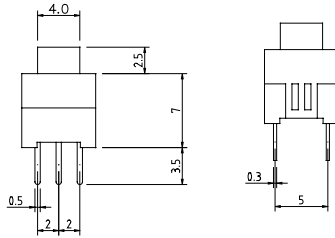
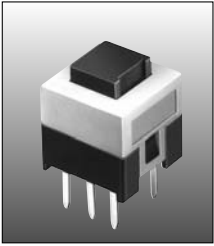

Model No.	Operating Mode	Stroke	Operating Force
2212FS	Self-Lock	Full:1.8mm	200±80gf
2212FN	Non-Lock	Lock:1mm	

2213

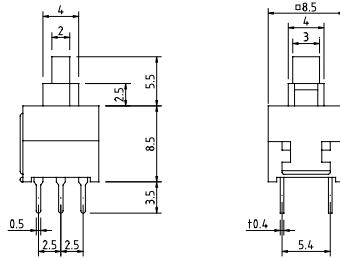
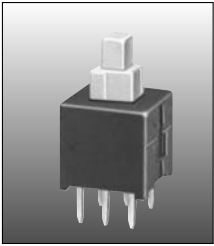

Model No.	Operating Mode	Stroke	Operating Force
2213S	Self-Lock	Full:2.5mm Lock:1.5mm	200±80gf
2213N	Non-Lock		
2213M	With Lock		

2215

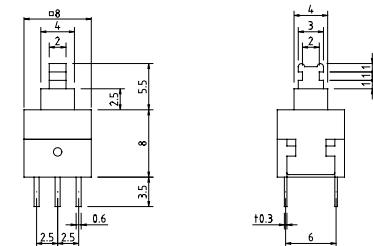
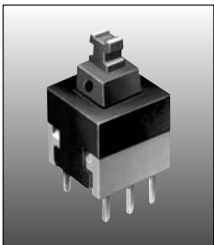

Model No.	Operating Mode	Stroke	Operating Force
2215S	Self-Lock	Full:2.5mm Lock:1.5mm	200±80gf
2215N	Non-Lock		
2215M	With Lock		

2216 series

2216

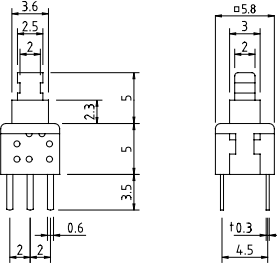
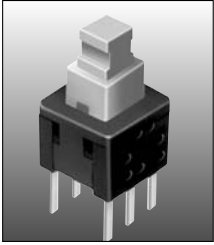

Model No.	Operating Mode	Knbo(mm)	Stroke	Operating Force
2216S	Self-Lock	2×2.5	Full:1.8mm Lock:1mm	150±80gf
2216N	Non-Lock	2×2.5		
2216SA	Self-Lock	2.5×2.5		
2216NA	Non-Lock	2.5×2.5		

2216F

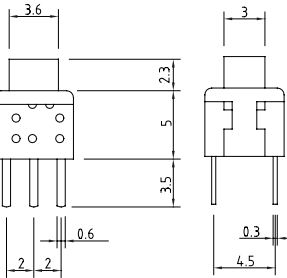
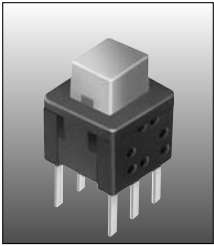

Model No.	Operating Mode	Knbo(mm)	Stroke	Operating Force
2216FS	Self-Lock	2×2.5	Full:1.8mm Lock:1mm	150±80gf
2216FN	Non-Lock	2×2.5		

2217

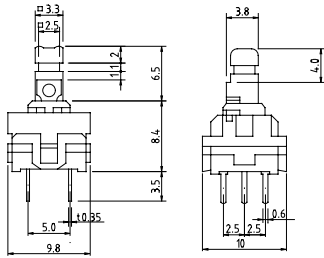
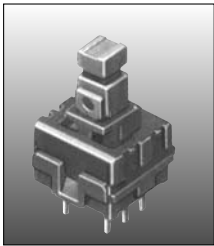

Model No.	Operating Mode	Stroke	Operating Force
2217S	Self-Lock	Full:1.7mm Lock:1.2mm	200±80gf
2217N	Non-Lock		
2217R	Reset		

2217A

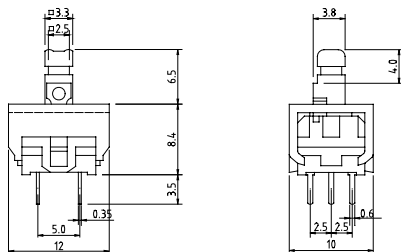

P.C.B. Land Pattern

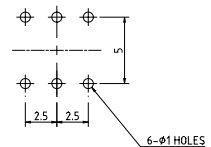

PUSH SWITCHES

01P series (16m/m Indicator & illuminated Push Switches)

Specifications

Rating	5A 250VAC
Operating Travel	3m/m
Actuating Force	120~250g
Mechanical Life	1,000,000 Cycles Min.
Dielectric Strength	4000 VAC 50Hz 1 minute
Safety Approval	UL CE D N S FI



How to order

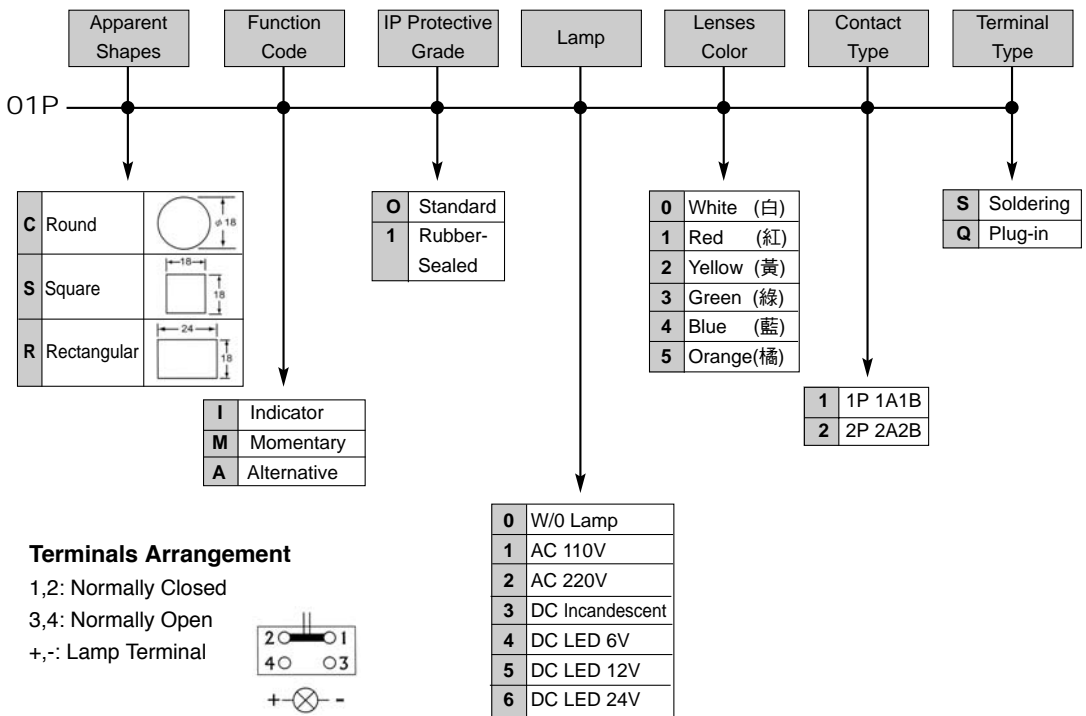

Terminals Arrangement

1,2: Normally Closed
 3,4: Normally Open
 +,-: Lamp Terminal

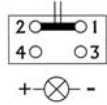

Electric Circuit

Momentary

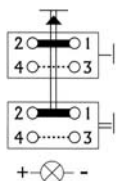

(+,- for mult-LED)

Alternative

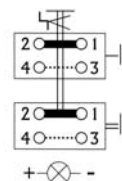

(+,- for mult-LED)

Panel Mounting

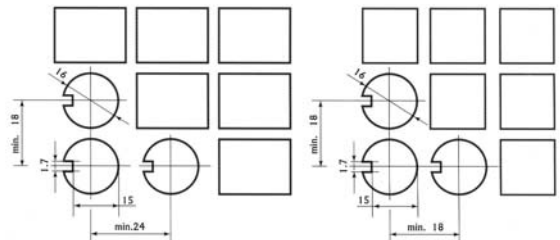

Unit : mm

(16m/m Indicator & illuminated Push Switches) **01P series**

01P-S-M-0-2-3-1-Q 01P-S-A-1-5-4-1-Q 01P-R-M-1-3-1-1-Q 01P-C-A-1-5-2-1-S 01P-C-A-1-2-0-2-S 01P-C-I-0-3-0

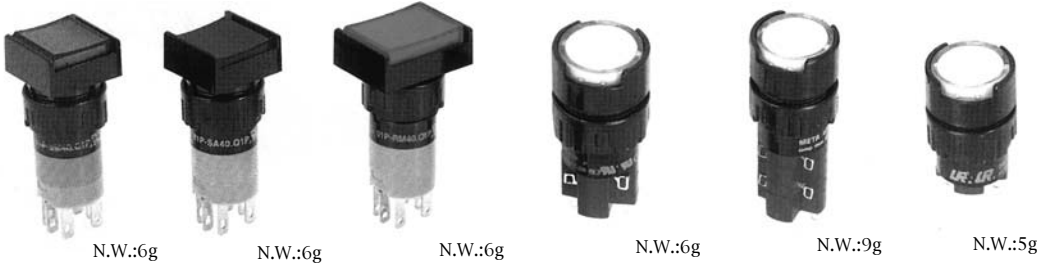

Apparent Shape & Dimension

Rectangular Shape

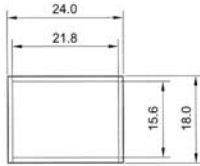

Square Shape

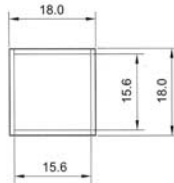

Round Shape

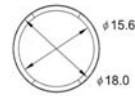

Plug-in Terminals 1A1B

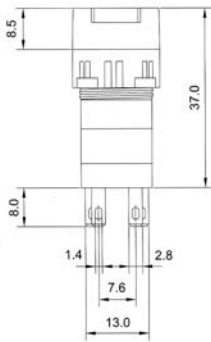

Soldering Terminals 2A2B

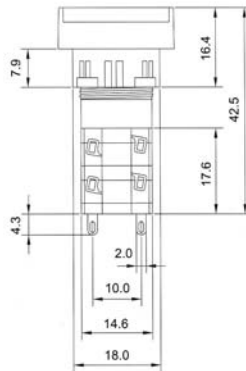

Soldering Terminals 1A1B

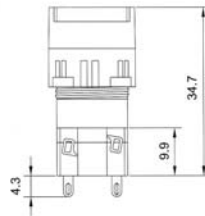

Soldering Indicator

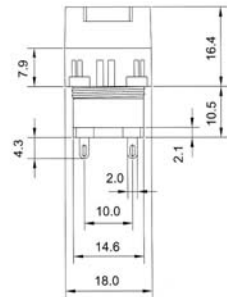

Accessory

01P-100



Anti Twisting Ring

01P-200R
(Rectangular)



Protective Cover

01P-200S
(Square)



Protective Cover

01P-300



PCB Plug-in Base

PUSH SWITCHES

RL5-1 series

Specifications

Rating	10(4)A 250 VAC T125	
	16(6)A 250 VAC T125	
Contact Resistance	20mΩ (max.)	
Insulation Resistance	DC 500V 100MΩ (min.)	
Dielectric Strength	1500VAC / 1 Minute	



How to order

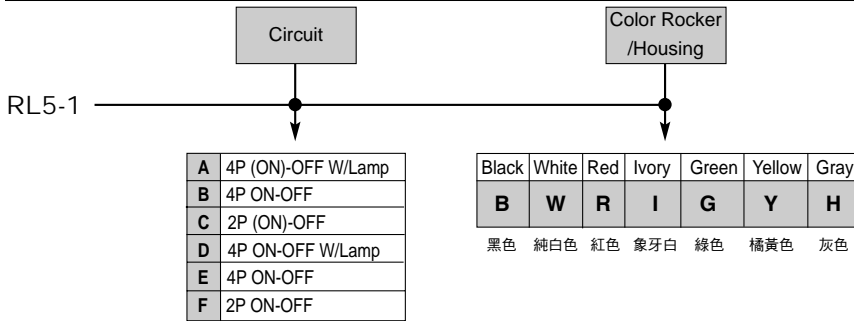

RL5-1-D-R/B



RL5-1-E-B/B



RL5-1-A-Y/B



RL5-1-B-W/B

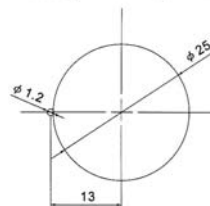
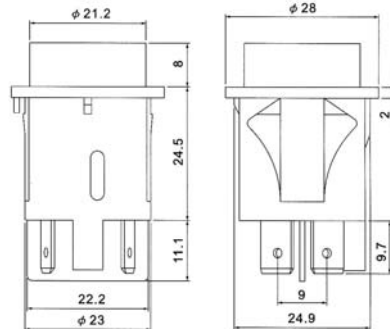

JS-701 series

Specifications

Rating	5A 125VAC / 3A 250VAC
Contact Resistance	30mΩ (max.)
Insulation Resistance	DC 500V 100MΩ (min.)
Operating Force	250±50g



How to order

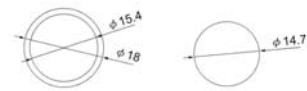
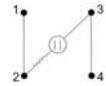
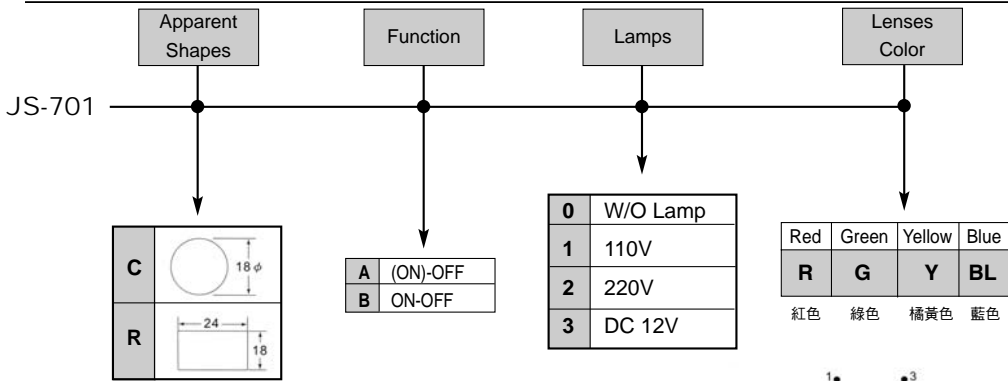

JS-701-C-A-1-BL JS-701-C-A-1-G



N.W.:6g



N.W.:6g

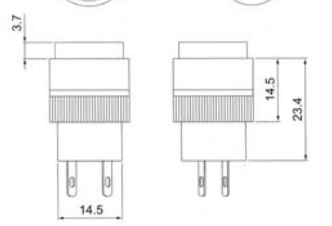

JS-701-R-B-2-Y JS-701-R-B-1-R



N.W.: 7g



N.W.:7g

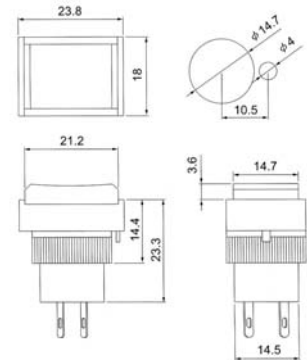

JS-758 series

Specifications

Rating	K:3A 125VAC / 1A 250VAC T85 H:10A 125VAC / 6A 250VAC T: 16A 125VAC / 10A 250VAC
Contact Resistance	50mΩ (max.)
Insulation Resistance	DC 500V 100MΩ (min.)
Dielectric Strength	AC 1500VAC / 1 Minute
Operating Force	400±50g



How to order

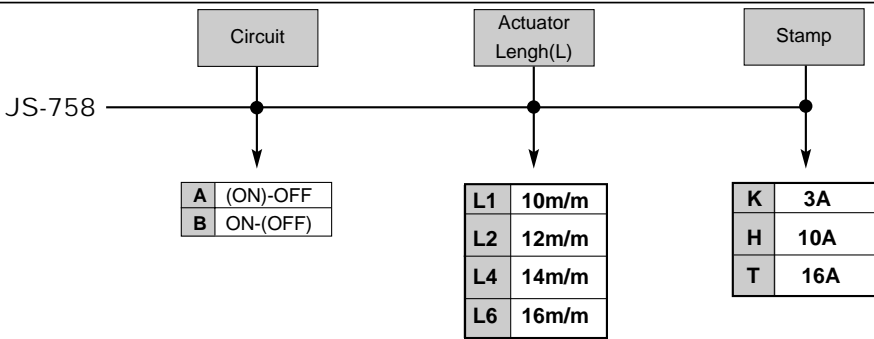

JS-758A-L1-H

JS-758A-L2-T



N.W.:4g



N.W.:4g

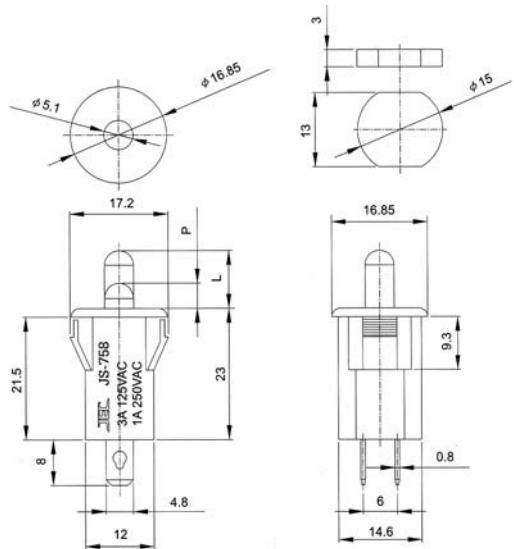

JS-758A-L4-K

JS-758A-L6-T



N.W.: 4g



N.W.:4g

JS-706 A:(ON)-OFF B:ON-(OFF)

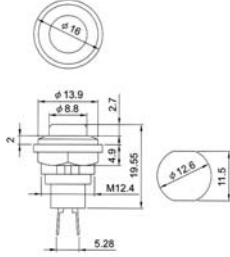

JS-707 A:(ON)-OFF

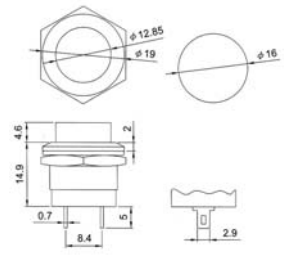

JS-708 A:(ON)-OFF B:ON-(OFF)
AL:W/LED(ON)-OFF BL:W/LED ON-OFF

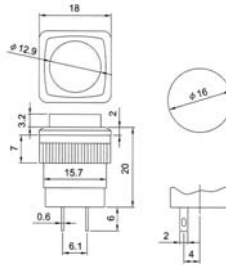

JS-711 A:(ON)-OFF B:ON-(OFF)

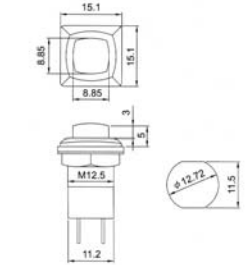

JS-722 A:(ON)-OFF B:ON-(OFF)

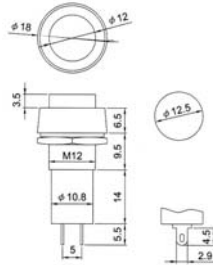

JS-722S A:(ON)-OFF B:ON-(OFF)

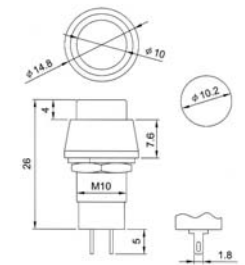

JS-723 A:(ON)-OFF B:ON-(OFF)

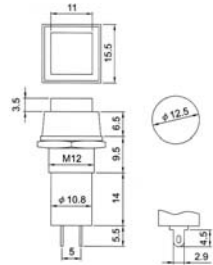

JS-723S A:(ON)-OFF B:ON-(OFF)

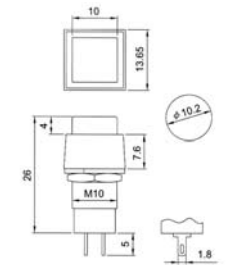

JS-724 A:(ON)-OFF B:ON-(OFF) C:ON-(OFF)

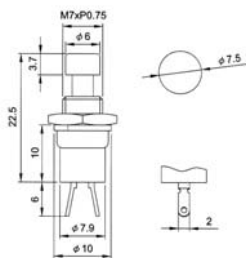

JS-725 A:(ON)-OFF B:ON-(OFF) C:ON-(OFF)

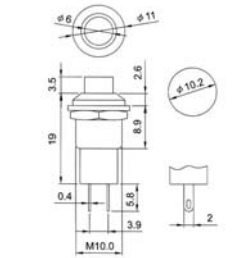

PUSH SWITCHES

JS-740 A:(ON)-OFF B:(ON)-OFF



N.W.:5.5g

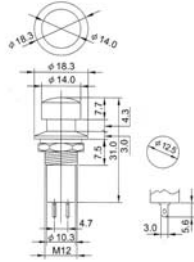

JS-740S A:(ON)-OFF B:(ON)-OFF



N.W.:6g

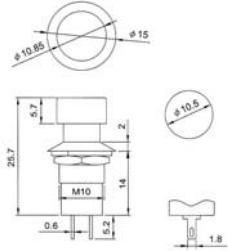

JS-746 A:(ON)-OFF B:(ON)-OFF



N.W.:2g

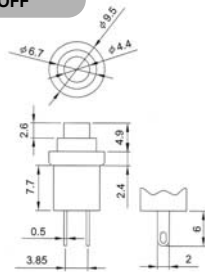

JS-756 A:(ON)-OFF With Separator B:(ON)-OFF W/O Separator



N.W.:2.5g

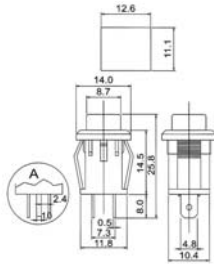

JS-757 A:(ON)-OFF B:(ON)-OFF



N.W.:2.5g

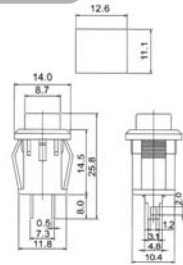

JS-757 C:(ON)-OFF D:(ON)-OFF



N.W.:2.8g

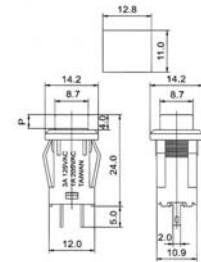

JS-760 A:(ON)-OFF



N.W.:3.5g

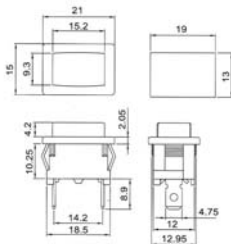

JS-761 A:(ON)-OFF



N.W.:1g

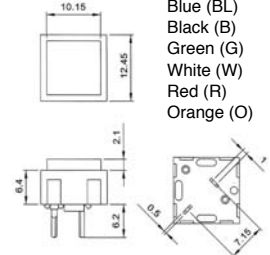

Cap Color:
Blue (BL)
Black (B)
Green (G)
White (W)
Red (R)
Orange (O)

JS-762 A:(ON)-OFF

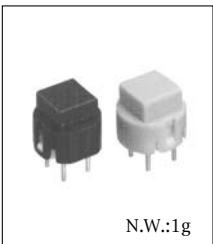

N.W.:1g

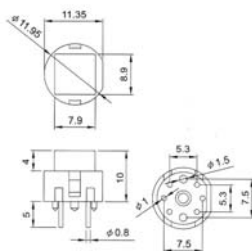

JS-763 A:(ON)-OFF



N.W.:1g

