

1120 series

SW-110

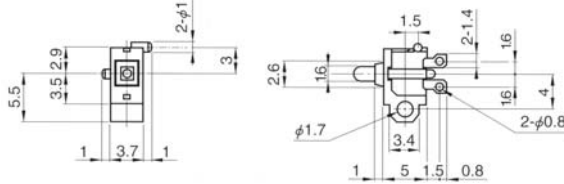

Rating:100mA 12V DC
 Circuit-Position:1C-1P Normal Open
 Contact Resistance:1 Ω MAX

SW-111

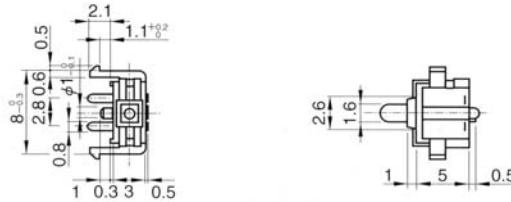

Rating:100mA 12V DC
 Circuit-Position:1C-1P Normal Open
 Contact Resistance:1 Ω MAX

SW-150

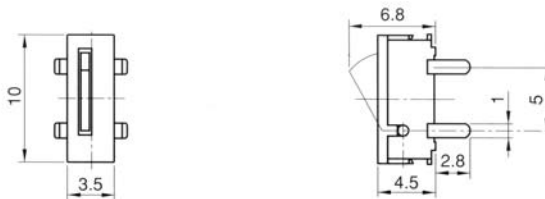

Rating:1mA 5V DC
 Circuit-Position:1C-1P Normal Open
 Contact Resistance:1 Ω MAX

SW1AB-350



Rating:0.1~5mA 5V DC
 Circuit-Position:1C-1P Normal Open
 Contact Resistance:1 Ω MAX

DETECT SWITCHES

DS Series

SW1AB-420-T35

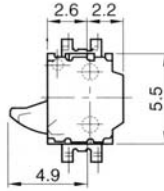
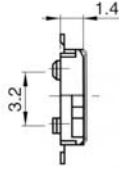

Rating:0.1~10mA 5V DC
Circuit-Position:1C-1P Normal Open
Contact Resistance:1Ω MAX

TPS-12NTL

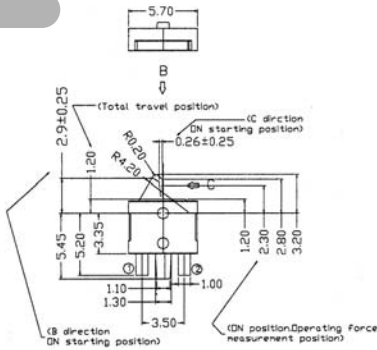

P.C.B. Land Pattern

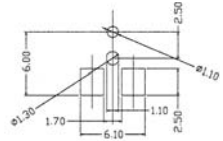

Circuit Diagram

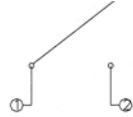

TPS-12MTL

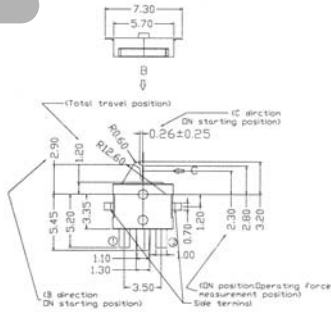

P.C.B. Land Pattern

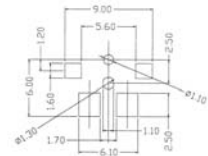

Circuit Diagram

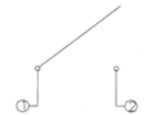

TPS-12NTR

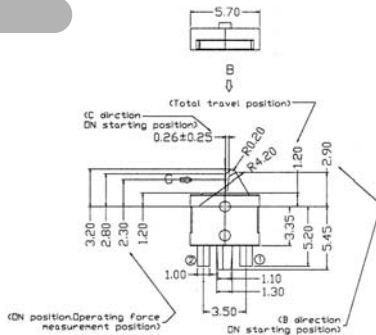

P.C.B. Land Pattern

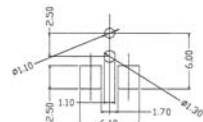

Circuit Diagram

